

# Meissen Keramik

## **INSTALLATION INSTRUCTIONS**

for the GENERA Manual Shower Toilet

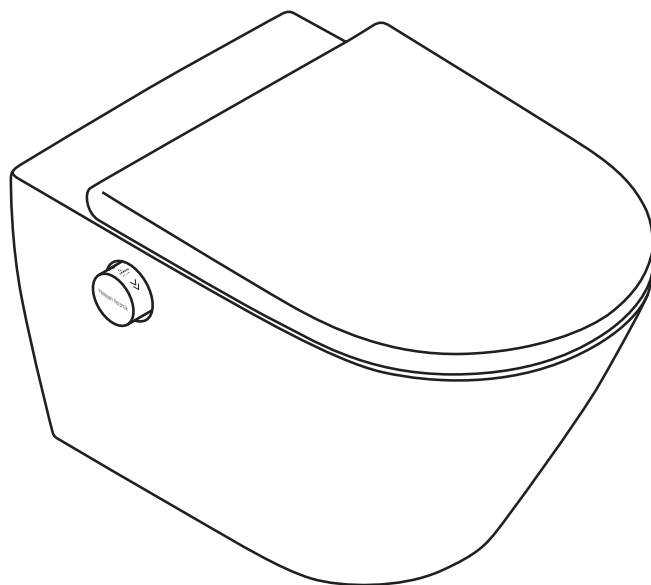



**Installation should be carried out by a qualified person.**



Read the installation instructions and safety instructions carefully before installing the shower toilet.

## Symbols and their meaning

---



### Caution

This symbol indicates hazards that may lead to injury and/or damage to the shower toilet or other property if ignored.

## Safety instructions

---



The water supply line to the toilet should only be installed by qualified plumbers.



Follow national/regional standards and local installation regulations.



Do not install the device in a room where the temperature is below 4°C. This may result in damage to the device.

## Caution

---



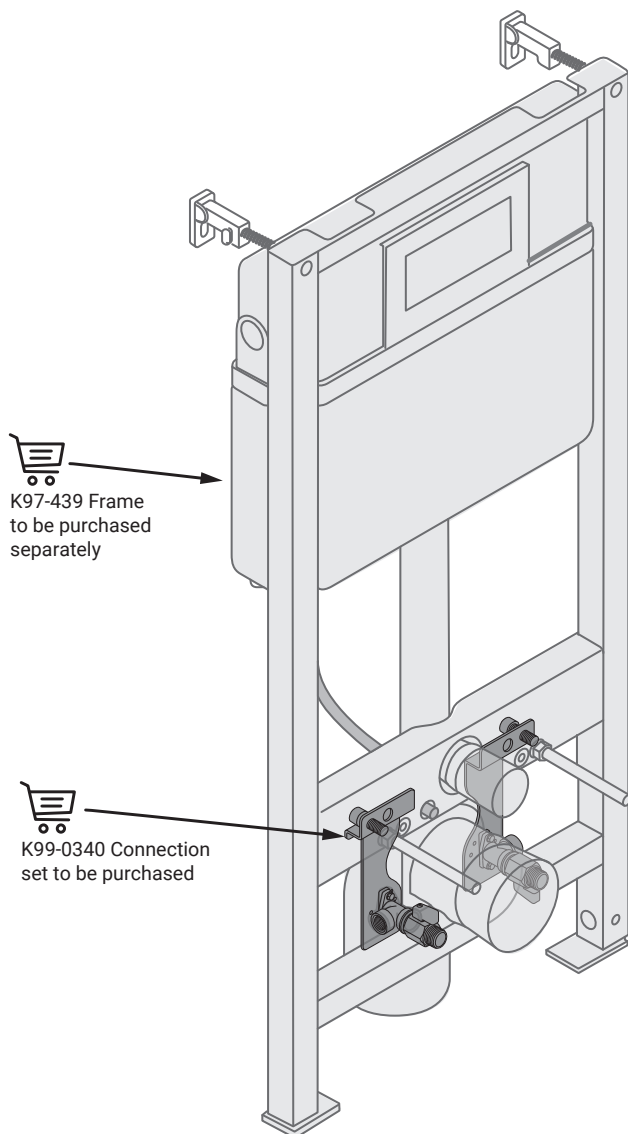

For easy installation, we suggest using the Eterna concealed installation kit (K97-439) with the Genera manual shower toilet connection kit (K99-0340)





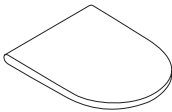
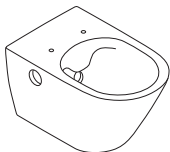
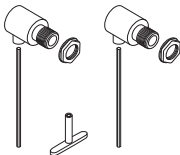

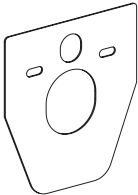

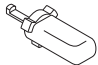
## Summary of components



These instructions apply to installation with the K97-439 concealed kit and the K99-0340 connection kit. When installing on other manufacturer's frames, make sure in advance if it will be possible to install the bowl.

 <p>Toilet seat</p>	 <p>Ceramic bowl with shower system</p>	 <p>Bowl mounting kit</p>	 <p>Installation Instructions and Operating Instructions</p>
 <p>Foam pad</p>	 <p>Slide paste</p>	 <p>Additional washing nozzle tips</p>	 <p>Tool for removing the washing nozzle</p>

## Tools needed for installation

 <p>Measuring tape</p>	 <p>Monkey wrench</p>	 <p>Saw</p>	 <p>Spirit level</p>
 <p>File</p>	 <p>Pen</p>		

# Installing the ceramic wall-hung toilet bowl and preparing the water supply



## Danger

The installation of the bowl and the preparation of the water connection should be carried out by a qualified person with the appropriate authorization. If you break a ceramic bowl, use extreme caution. **Ceramic pieces are very sharp and can cause injury!**

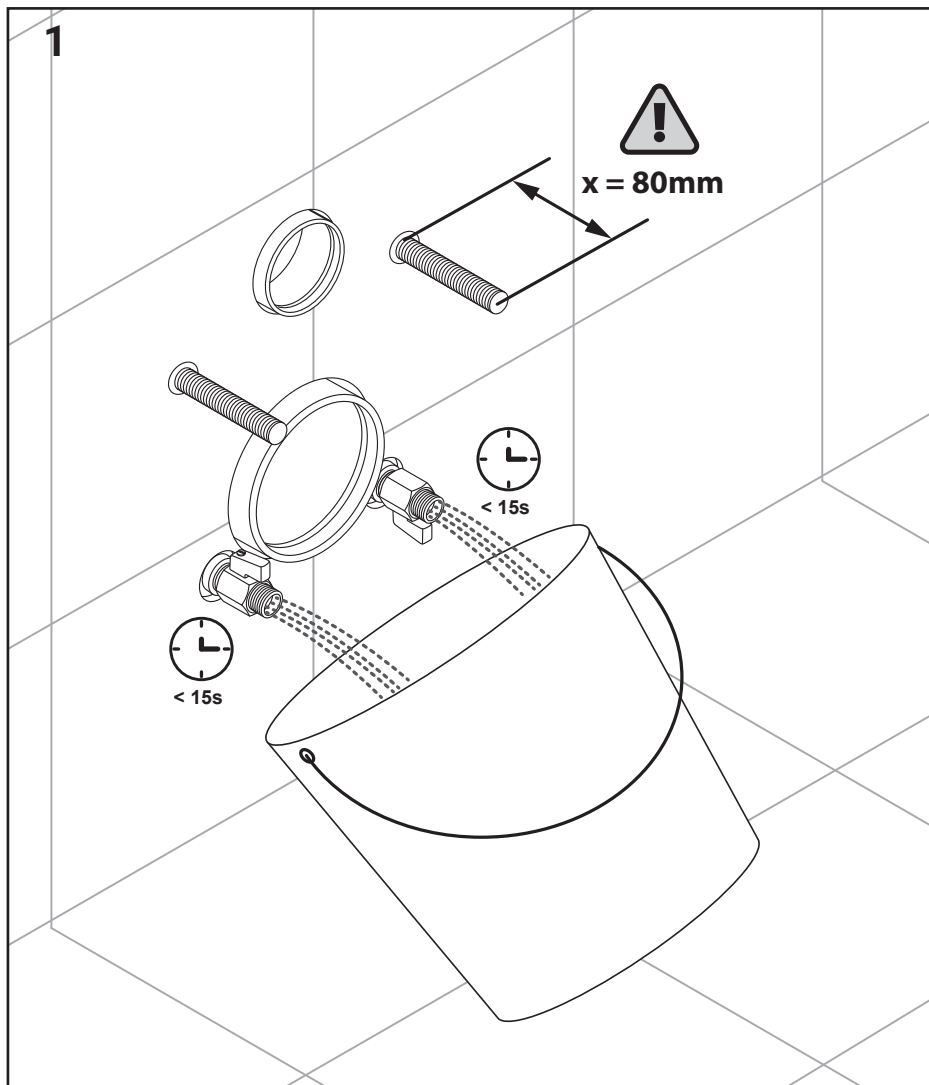

2

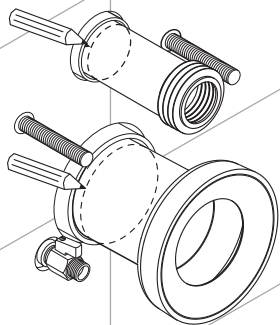

3

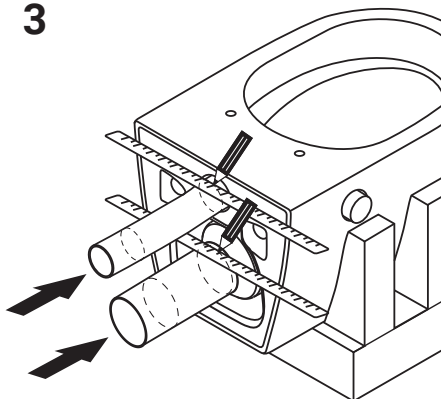

4

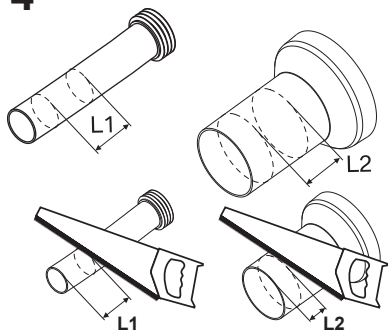

5

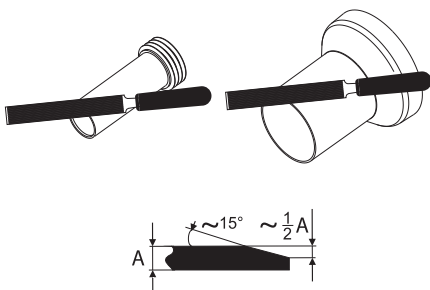

6

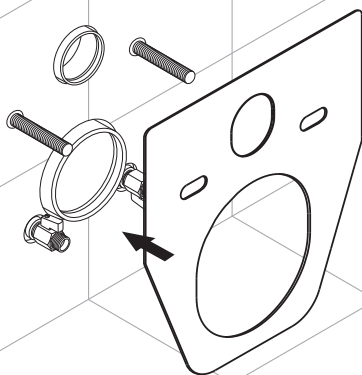

7

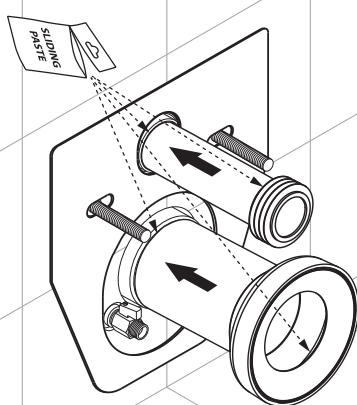

8

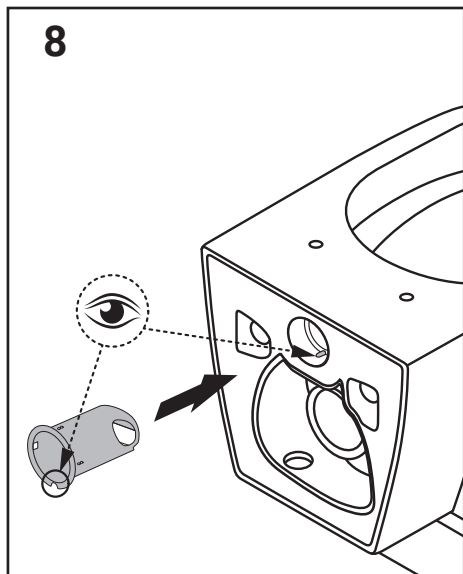

9

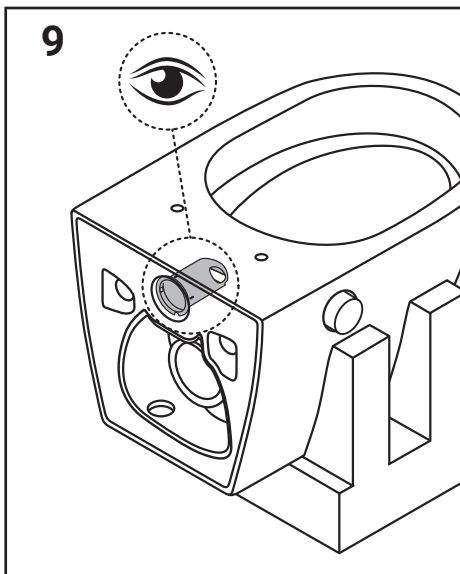

10

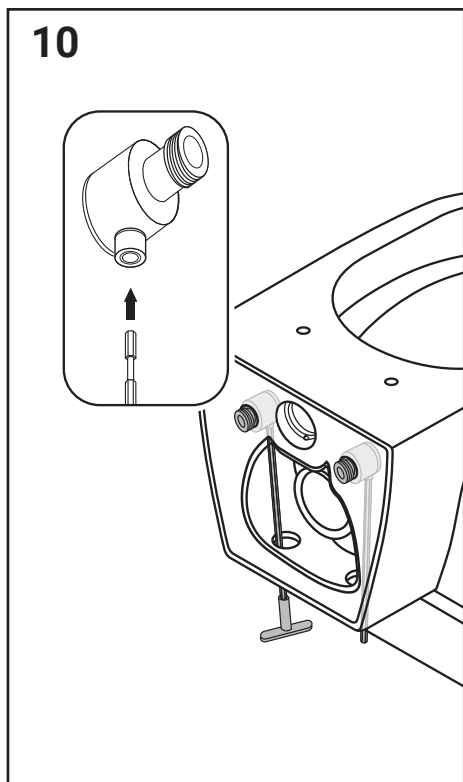

11

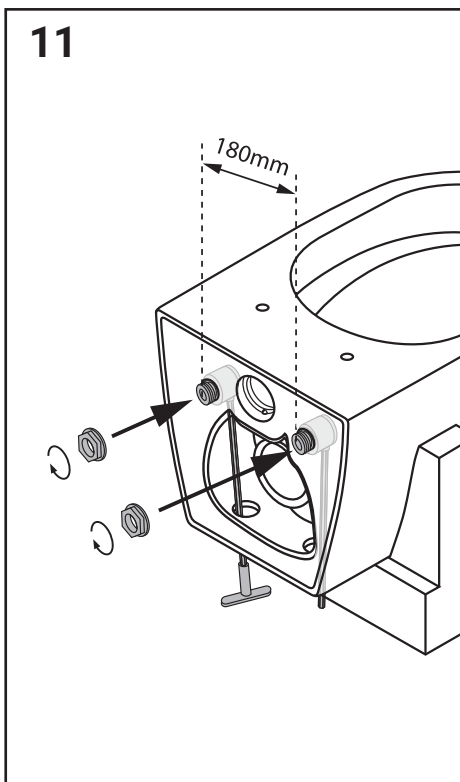

12

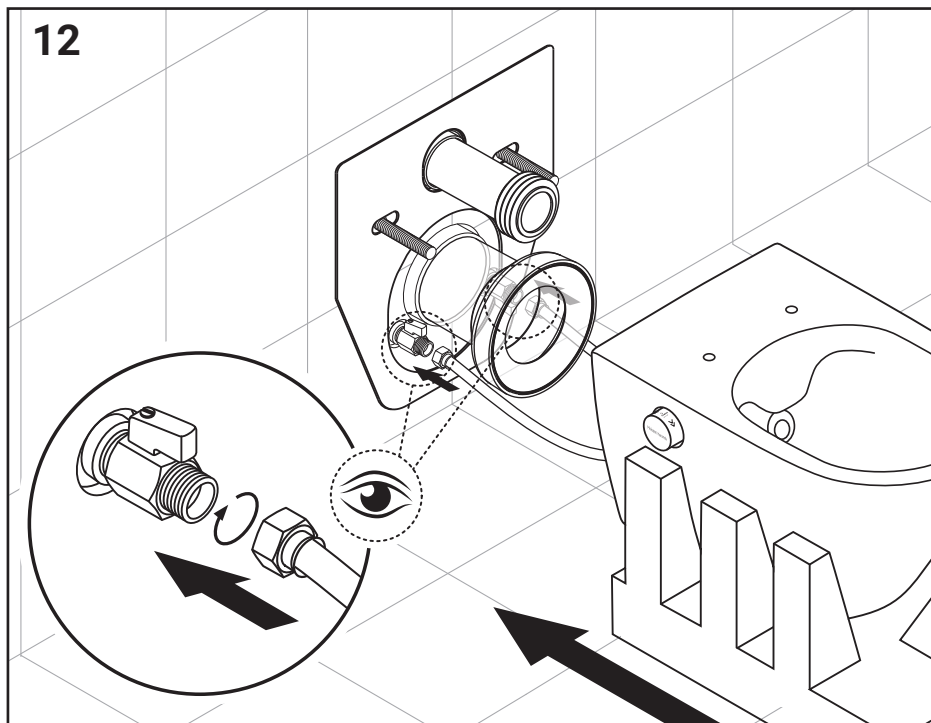

13

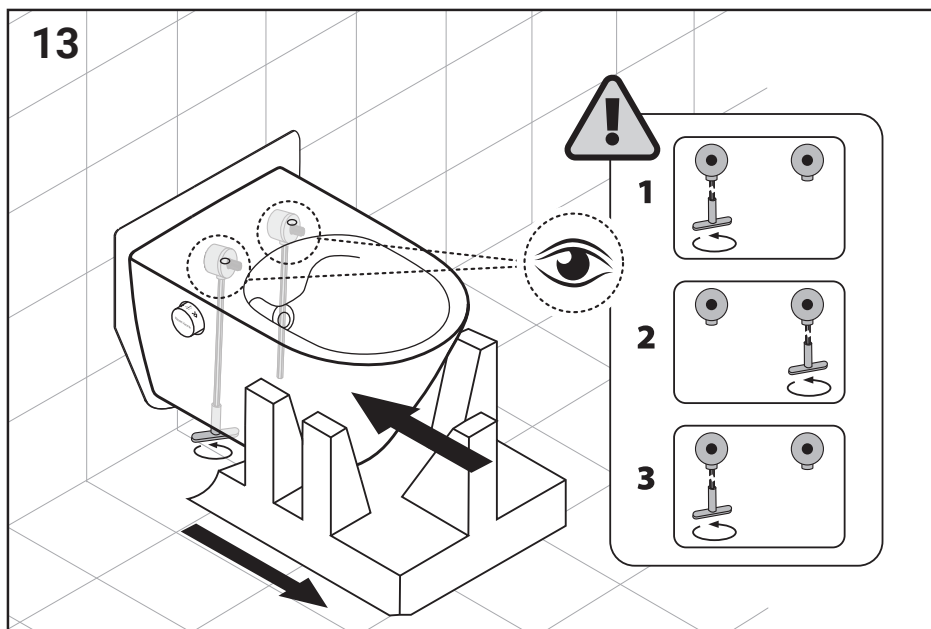



14

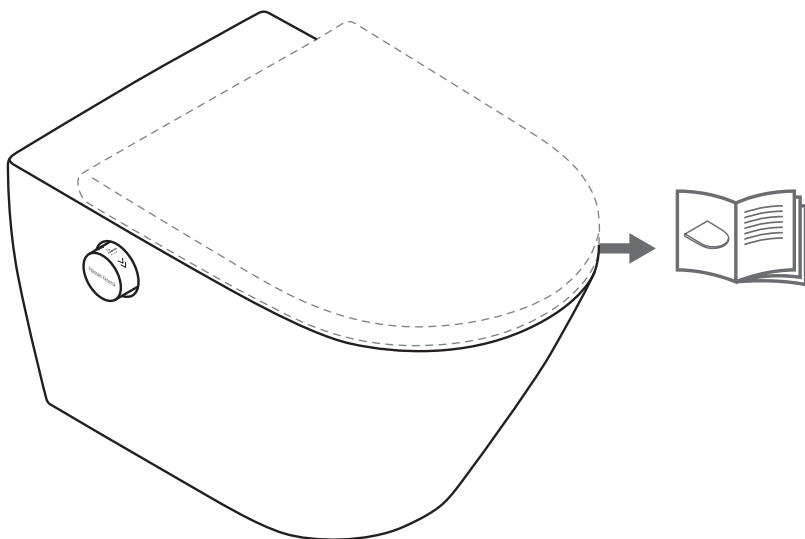
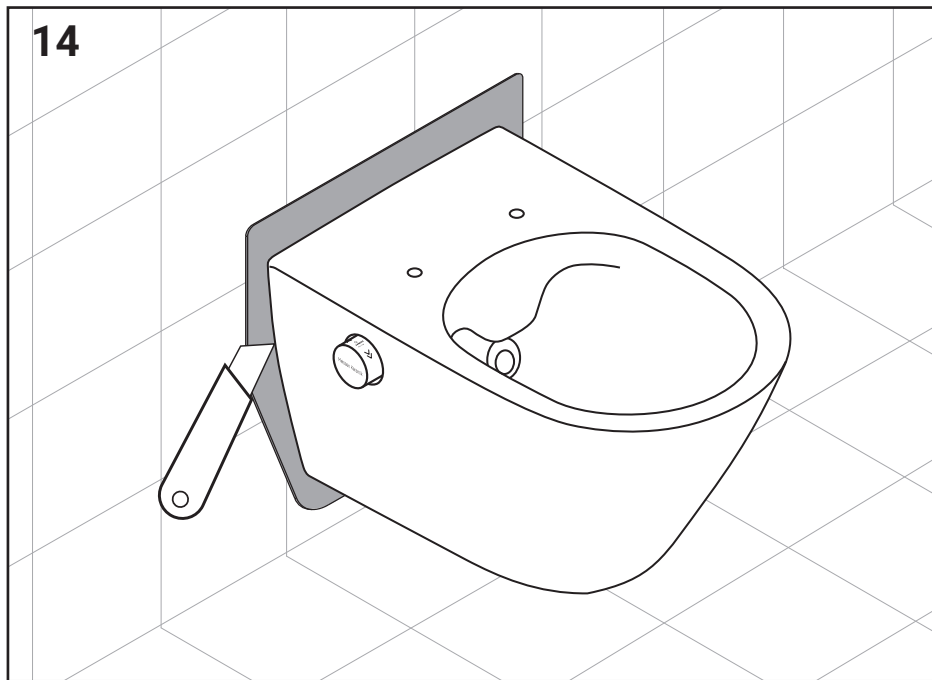

# Meissen Keramik

**Thank you for trusting us**