

Meissen Keramik

USER MANUAL

shower toilet GENERA Comfort

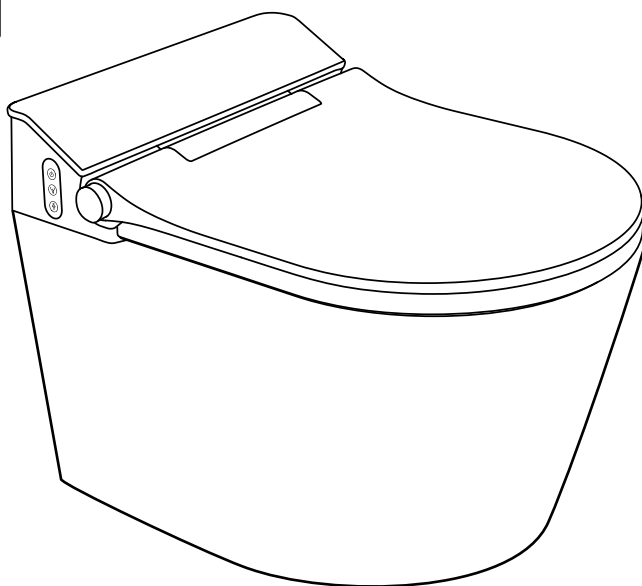

Thank you for purchasing MEISSEN KERAMIK shower toilet.

IMPORTANT:

Read and understand this manual before installing and using this product!

The illustrations in this manual are for reference only and may differ from the actual appearance of the product.

Features and available functions of the shower toilet GENERA Comfort

Washing	Standard wash	●
	Feminine wash	●
	Oscillation wash	●
	Water spray intensity adjustment	●
	Water temperature adjustment	●
	Spray nozzle position adjustment	●
Hygiene	Nozzle self-cleaning	●
	Replaceable nozzle tip	●
	Descaling function	●
	Antibacterial nozzle	●
	Easily detachable toilet seat and lid	●
	Easily removable shower system	●
Comfort	Soft-close toilet seat	●
	Night light	●
	Instantaneous water heating	●
	Knob control	●
	Remote control	●
Safety	EN1717	●
	IPX4	●
	CE	●
	RoHS	●

Table of contents

- Chapter 1 Safety principles 2**
 - 1.1 Symbols and their meaning 2
 - 1.2 Safety considerations. 3
 - 1.3 Precautions for use 7
- Chapter 2 General product characteristics 8**
 - 2.1 Shower toilet design. 8
 - 2.2 Remote control 10
- Chapter 3 Operating instructions 11**
 - 3.1 Starting the shower toilet. 11
 - 3.2 Knob control 14
 - 3.3 Control with side buttons. 14
 - 3.4 Remote control 15
- Chapter 4 Cleaning and maintenance 20**
 - 4.1 Shower toilet cleaning 20
 - 4.2 Spray nozzle cleaning. 20
 - 4.3 Descaling 21
 - 4.4 Remote control cleaning 22
 - 4.5 Waste disposal 22
 - 4.6 Product maintenance. 22
- Chapter 5 Troubleshooting 23**
- Chapter 6 Technical data 25**

Chapter 1 Safety principles

To ensure safe and trouble-free use of the shower toilet, read the user manual and observe the safety rules!

1.1 Symbols and their meaning



Warning

This symbol indicates hazards that may lead to death or injury if ignored.



Caution

This symbol indicates hazards that may lead to injury and/or damage to shower toilet or other property if ignored

Meaning of symbols:



MANDATORY
operation



PROHIBITED
operation

1.2 Safety considerations



Make sure that the power cord is not damaged!

Avoid crushing or jamming the power cord!

The power cord must not come into contact with heated surfaces and sharp edges!

If you have any questions about the operation of the appliance, please contact the customer service helpline to avoid product failure and damage caused by misuse.

Children and persons who do not understand the intended use of the product, or who have physical, sensory, mental or other disabilities, may use the product only if it has been explained to them how they can use it safely or under the supervision of other people.

The shower toilet is not a toy – children must not play with the product as this can lead to injuries or death.

Connect the appliance to the cold water supply system (temperature of about 4-35 degrees Celsius)

Do not use the shower toilet if it is not working properly.

In the event of a malfunction or failure, immediately disconnect the power supply, close the shut-off valve to cut off the water supply and stop using the shower toilet. Contact the customer service helpline.

Malfunctions and faults can manifest themselves as:

- a crack or damage to the product
- smoke coming out of the product
- unusual sound and smell of burning
- product heating up above normal operating temperature
- water leakage from pipes or the appliance

Using a damaged appliance may result in electric shock, fire, flooding or other damage.

Do not lift the product by gripping the lid.



When using in the bathroom, make sure that the power supply system is waterproof. If not, the risk of an electric shock or fire can occur.

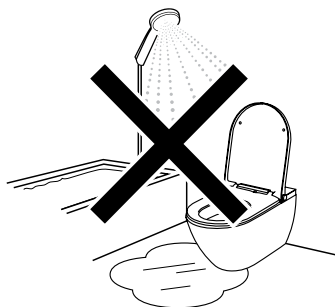



Warning



Do not immerse in or spray the appliance or electrical system with water or other liquids.

Electric shock, damage to the appliance or fire hazard.

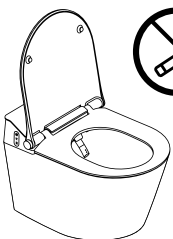

Do not place hot objects or flammable materials near the appliance.

Fire hazard.



Do not disassemble, modify or repair the appliance.

Electric shock, short circuit or fire hazard.

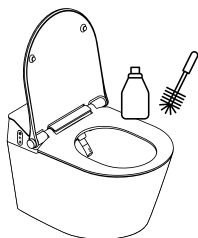

Take care not to flood the appliance connected to the power supply when cleaning.

Electric shock or fire hazard.



Make sure that the electrical system and bowl are earthed.

The appliance can only be connected to dedicated 220V-240V, 50/60Hz, 10A systems with residual-current device.



If the appliance will not be used for a longer period of time (several months), turn it off with the ON/OFF button.



Caution



Do not allow children to play, stand or sit on the lid. Do not place heavy objects on it.

This may lead to injuries or damage to the appliance.



Do not install the appliance in a room where the temperature is below 4°C.

This can damage the appliance.



Do not force the lid or seat to close.

This may cause damage to the product.



Do not kink, bend excessively or twist the water hose.

This may cause water leakage.



Do not use aggressive, concentrated or abrasive cleaning agents.

They can damage the product.



Do not use appliances near the shower toilet that could interfere with its operation.



Do not lean against the lid. This may cause damage or injury.



Do not supply contaminated water, seawater or untreated water to the appliance, as this may cause infection, skin irritation or damage to the product.

1.3 Precautions for use

Connect the appliance to the cold water supply system using the new hose supplied with the product. Use only new hoses to connect the shower toilet.

When moving the appliance from a cool to a warm room, condensation may occur on the surface of some system components. In such a situation switch the appliance on after a few hours to let the condensed steam evaporate.

Prevent the spray nozzle from contamination, splashing or blocking.

You can install a residual current device (RCD) as an additional protection. Do not use accessories that are not recommended by the manufacturer.

Control knob and remote control are supplied by CR2032 batteries.

In case of acid leakage from the battery, avoid contact with skin, eyes and mucous membranes.

In case of contact with acid, rinse contaminated areas with plenty of clean water and seek medical help immediately.

Keep batteries out of the reach of children. The battery can be life-threatening if swallowed. In case of swallowing the battery, seek medical attention immediately.

Do not charge the battery, use other means to reactivate it, dismantle it, throw it into fire or short-circuit its poles.

Remove depleted batteries from the remote control immediately. Otherwise, acid leakage from the battery may damage the remote control. Do not mix old and new batteries in the remote control.

Clean the contacts of the remote control before reinserting the batteries. When inserting the battery, pay attention to the correct polarity. If the remote control will not be used for a long time, remove the batteries.

Do not expose the battery to extreme conditions: do not place it on hot surfaces and do not expose it to direct sunlight. Otherwise there is an increased risk of leakage.

For information on how to remove and insert the battery, see point 3.1 of the manual.

Do not mix different types or used batteries.

Chapter 2 General product characteristics

2.1 Shower toilet design

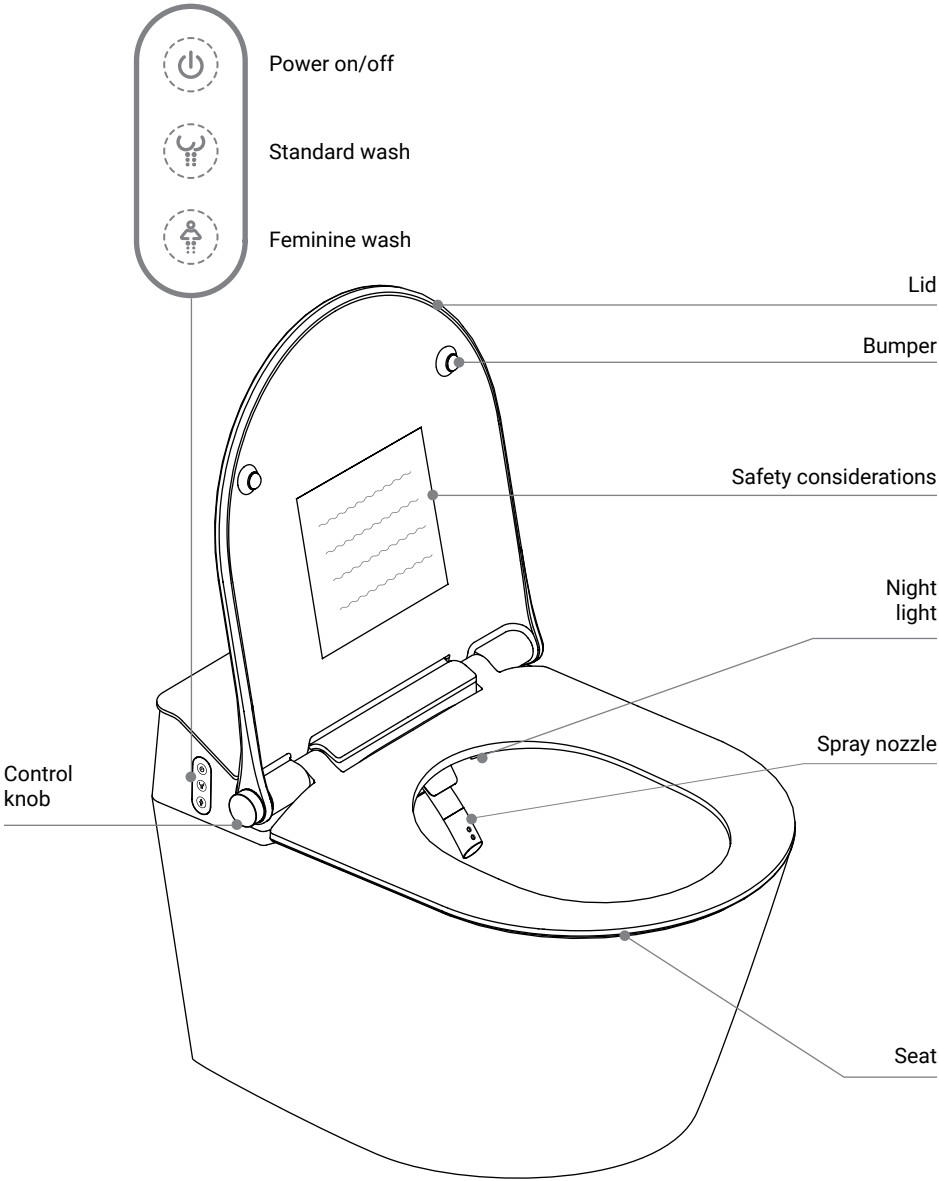

Bottom view

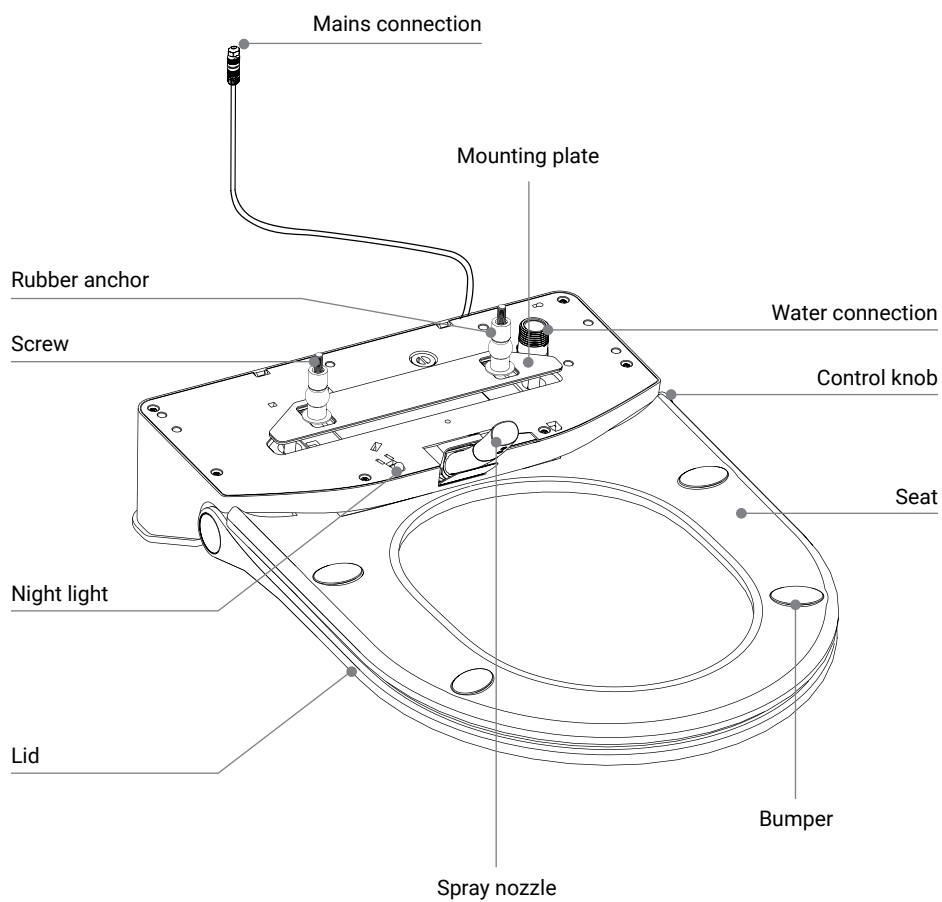

2.2 Remote control

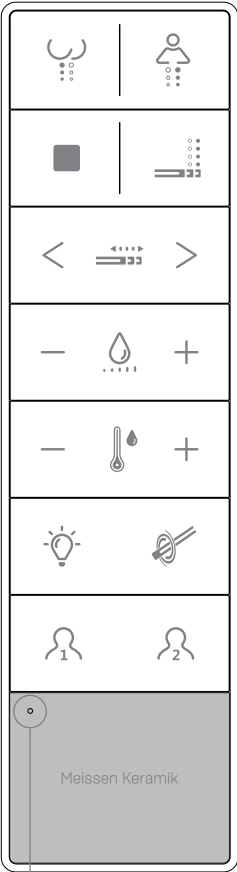

LED indicator

Symbol	Meaning
	Standard wash
	Feminine wash
	Stop
	Oscillation wash
	Water spray intensity adjustment
	Water temperature adjustment
	Nozzle position adjustment
	Night light
	Manual nozzle cleaning
	User settings 1
	User settings 2

(Detailed information describing the individual functions can be found in point 3.4.)

Chapter 3 Operating instructions

3.1 Starting the shower toilet

1. Remote control batteries

A. Remove the remote control from the holder.

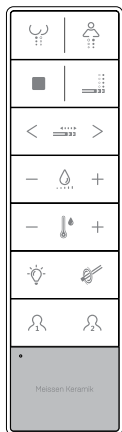

B. Firmly pull up (in the place marked with an arrow) and open the battery cover.

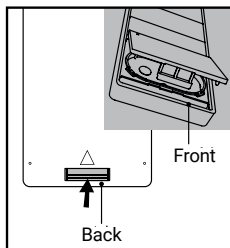

C. Insert two CR2032 batteries, remembering that +CR 2032 3 V is printed on their positive side.

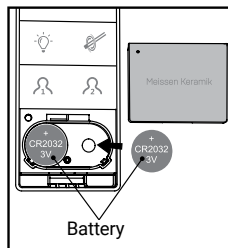

If the battery is installed correctly, the remote control LED will light up for 2 seconds.

D. Close the battery cover.

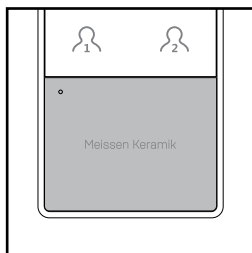

Use alkaline batteries. To prevent the battery from cracking or leaking, follow the instructions in the "Precautions for use" section of this manual (point 1.3.)

2. Pairing the remote control with the shower system

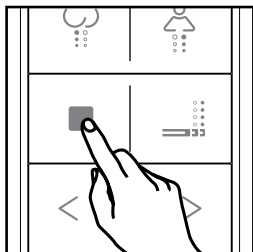

A. Turn the power supply to the shower toilet off, then press and hold the stop button until the LED on the remote control starts flashing.

B. Turn the power supply to the shower toilet on and wait 15-20 seconds

C. Check if the shower toilet responds to the remote control signals

D. If remote control and appliance pairing has failed, the on/off button LED on the side panel of the appliance will automatically switch off after 30 seconds. Try again. If the next attempt is unsuccessful, contact the service.

3. Control knob battery

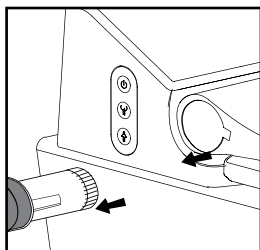

A. Remove the control knob.

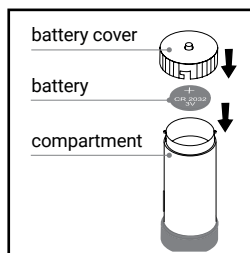

B. Open the cover and insert the battery with the positive side upwards. Use CR 2032 3V battery.

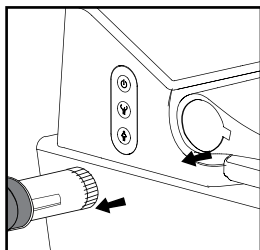

C. Insert the knob in an appropriate manner, paying attention to the position of the locking tab.

4. Pairing the control knob

If the knob does not work properly, you can pair the control knob with the shower base again, following the steps below:

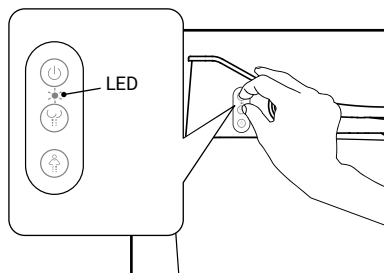

A. Press the on/off and standard wash buttons on the appliance at the same time and hold them until you hear a beep and the LED flashes for 10 seconds.

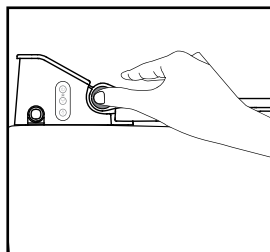

B. When the LED is flashing, press and hold the knob until you hear the beep again and the side button LED stops flashing. The appliance has been synchronized.

5. Starting the shower toilet

A. Make sure that the toilet is correctly connected to the power supply.



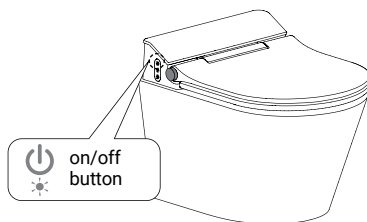

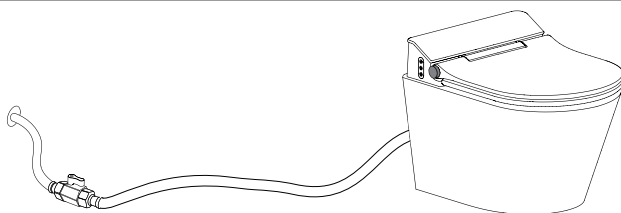

B. Press the “” button on the side panel and make sure that the LED is on.



C. Open the shut-off valve and check if there is water flow.



3.2 Knob control

			
Standard wash		Feminine wash	
			
Water spray intensity Nozzle position	Stop	Water spray intensity Nozzle position	Stop
<p>Turn the knob backward to activate the standard wash function.</p> <ol style="list-style-type: none">1. A short beep indicates that the function is on/off. Duration: 3 min.2. Press the knob to stop the wash function.3. You can adjust water spray intensity during washing (5 levels) with a knob.4. You can adjust the position of the nozzle during washing by pressing and turning the knob.		<p>Turn the knob forward to activate the feminine wash function.</p> <ol style="list-style-type: none">1. A short beep indicates that the function is on/off. Duration: 3 min.2. Press the knob to stop the washing function.3. You can adjust water spray intensity during washing (5 levels) with a knob.4. You can adjust the position of the nozzle during washing by pressing and turning the knob.	

3.3 Control with side buttons

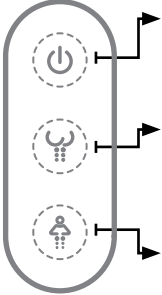
	<p>Power on/off</p> <p>Standard wash</p> <p>Feminine wash</p>	<p>Naciśnij przycisk zasilania, aby włączyć/wyłączyć urządzenie.</p> <p>Press the "Standard wash" button to activate the standard wash function. The washing process will be completed by pressing the "Standard wash" button again or automatically after 3 minutes.</p> <p>Press the "Feminine wash" button to activate the feminine wash function. The washing process will be completed by pressing the "Feminine wash" button again or automatically after 3 minutes.</p>
---	---	--

3.4 Remote control

The shower toilet can be operated with the control knob or remote control. Press the appropriate button on the remote control to activate given function.

■ Stop

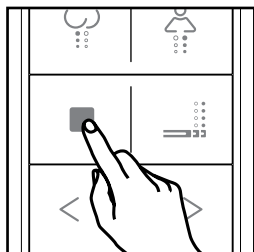

Press the "Stop" button to stop the current function.



Standard wash

Press the "Standard wash" button. You will hear a beep and the standard wash function will be activated.

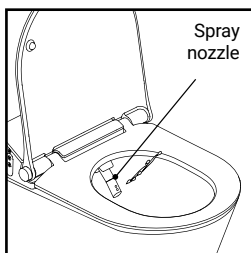

A. After activating the "Standard wash" function, the nozzle will be automatically rinsed, then it will extend and start washing.

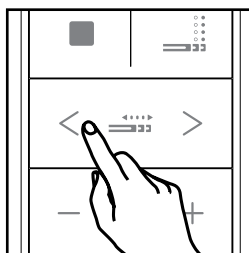

B. During standard wash, press ">" in "nozzle position adjustment" to move the nozzle forward; press "<" to move the nozzle backward. It is possible to set 5 nozzle positions.

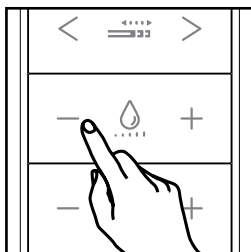

C. During standard wash, press "+" in "water spray intensity adjustment" to increase water spray intensity; press "-" to decrease water spray intensity. It is possible to set 5 water spray intensity levels.

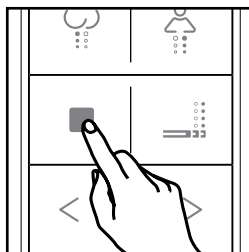

D. Press the "Stop" button to finish standard wash, or wait 3 minutes until the process is automatically completed.



Feminine wash

Press the "Feminine wash" button. You will hear a beep and the feminine wash function will be activated

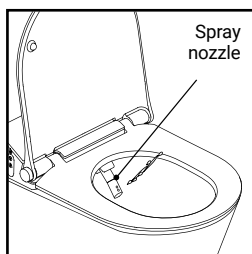

- A.** After activating the "feminine wash" function, the nozzle will be automatically rinsed, pulled out and will start washing.

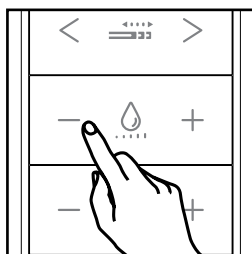

- C.** During feminine wash, press "+" in "water spray intensity adjustment" to increase water spray intensity; press "-" to decrease water spray intensity. It is possible to set 5 water spray intensity levels.

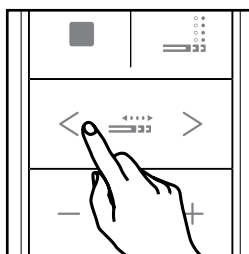

- B.** During feminine wash, press ">" in "nozzle position adjustment" to move the nozzle forward; press "<" to move the nozzle backward. It is possible to set 5 nozzle positions.

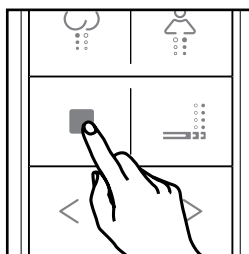

- D.** Press the "Stop" button to finish feminine wash or wait 3 minutes until the process is automatically completed.



Oscillation wash

Press the “Oscillation wash” button to start the function where the spray nozzle will move forward and backward alternately.

Condition: Standard or feminine wash function is enabled

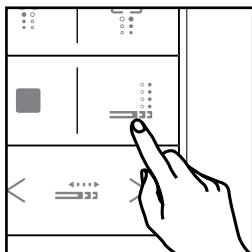

A. When the “oscillation wash” function is activated, the nozzle moves alternately forwards and backwards.

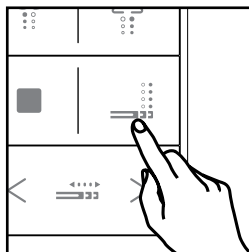

B. Press the oscillation wash button again to finish it, or wait 3 minutes until the oscillation wash is automatically completed.



Water temperature adjustment

It is possible to set 5 water temperature levels.

Condition: standard or feminine wash function is enabled.

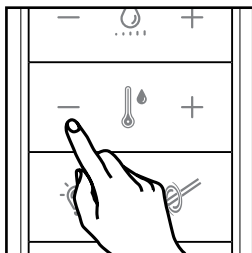

A. Press the “—” button in “water temperature settings” to decrease the temperature.

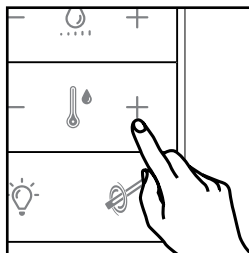



B. Press the “+” button in “water temperature settings” to increase the temperature.



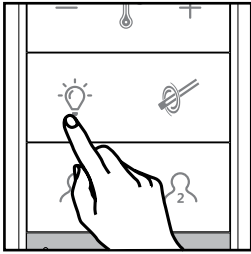

Night light

Switching night light on/off

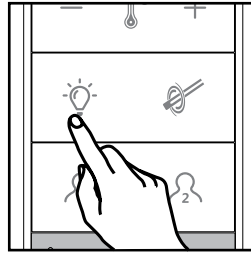

A. Press the “” button to activate the night light function.



B. Press the “” button again to turn off the night light function.



User settings 1

Enable/disable user settings 1.

Set the following parameters; position of the spray nozzle, water spray intensity, water temperature, night light.

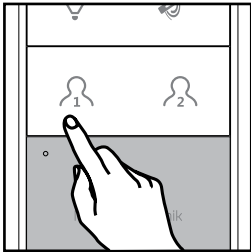

A. Press the “” button for at least 5 seconds to assign the parameters set to user settings 1.

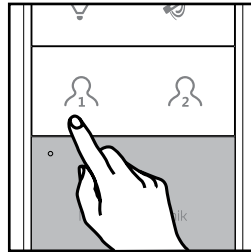

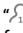
B. Press the “” button to enable the user settings 1 function.



User settings 2

Enable/disable user settings 2.

Set the following parameters; position of the spray nozzle, water spray intensity, water temperature, night light.

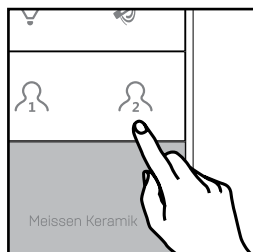

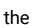
A. Press the “” button for at least 5 seconds to assign the parameters set to user settings 2.

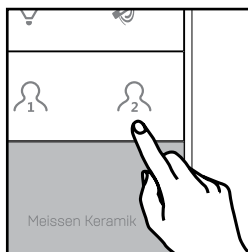

B. Press the “” button to enable the user settings 2 function.

Chapter 4 Cleaning and maintenance

4.1 Shower toilet cleaning

Clean the appliance and wipe out any dirt on a regular basis. If the product is not cleaned regularly, it can lead to dirt buildup that is difficult to remove. Take care not to flood the appliance connected to the power supply when cleaning.

Be careful not to allow water or detergent to enter the electrical connector, as this may cause an electric shock, fire or short circuit.

Do not use abrasive cleaning agents or those containing chlorine or acids.

Follow the instructions of the cleaning agent manufacturer.

Do not mix different cleaning products.

Use a mild soap solution for daily cleaning.

4.2 Spray nozzle cleaning



The spray nozzle and nozzle arm are rinsed automatically before and after each washing cycle (standard wash / feminine wash). Irrespective of this, clean the spray nozzle manually and wipe out any dirt on a regular basis, following the instructions below:

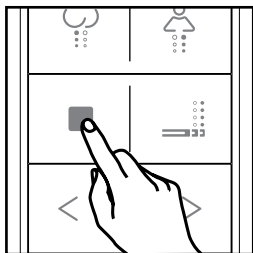

A. Press and hold the stop button to make sure that the toilet is in standby mode.

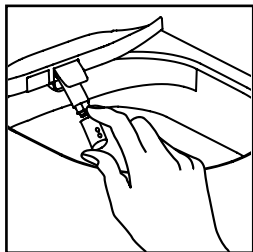

C. The nozzle will extend without activating the cleaning function. Clean the nozzle manually with a sponge and/or replace the nozzle tip if necessary.

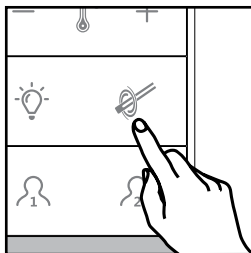

B. Press the "manual nozzle cleaning" button.

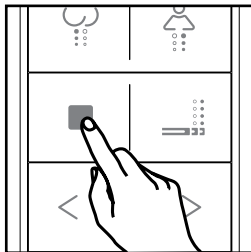

D. To complete the process, press the "stop" button so that the nozzle retracts into the shower system.

4.3 Descaling

Descal the appliance regularly to prevent limescale deposits, which may cause malfunction or damage.

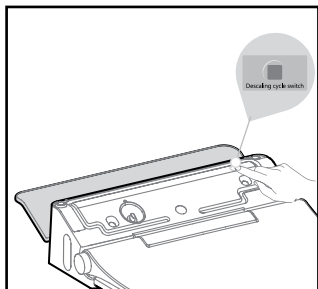

A. Open the rear cover.

B. Press the descaling cycle switch to start emptying the tank. A beep sound indicates that the process is finished.

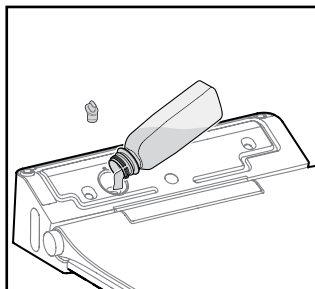

C. Open the filler plug and pour the descaling agent as shown in the figure (approx. 200ml). Use descaling agents for coffee machines and electric kettles.

Maximum of 250 ml of descaling agent can be poured into the shower system.

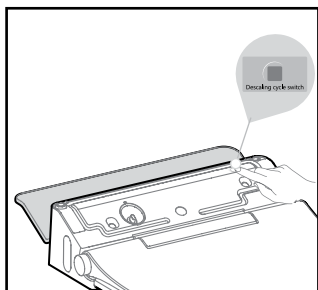

D. Press the descaling cycle switch again to start the descaling cycle.

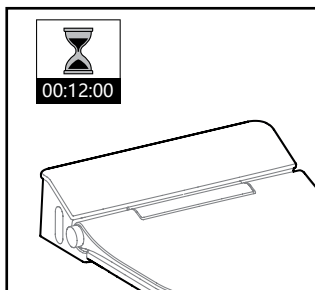

E. The descaling process will be carried out automatically and will be completed after approximately 12 minutes.

Caution: the descaling agent must be purchased separately.

The manufacturer recommends using a descaling agent intended for coffee machines and kettles.

4.4 Remote control cleaning

Use a soft, damp cloth or sponge to clean the remote control. Avoid spilling water or other liquid on the remote control, as this will damage it.

4.5 Waste disposal

Waste electric and electronic equipment (WEEE) may contain dangerous and hazardous substances. Do not dispose of this appliance as unsorted municipal waste. Return it to a designated collection point for the recycling of WEEE Contact your point of sale or relevant authorities for more information.

Used batteries must be disposed of properly. Battery recycling containers can be found in shops where batteries are sold and at local collection points.

Children must not play with plastic bags, batteries or packaging material. Store such material safely or dispose of it in an environmentally-friendly manner.

4.6 Product maintenance

Close the shut-off valve and disconnect the water supply hose when:

- there is a risk that water may freeze
- the appliance is not used for a longer period time (several months). Otherwise, it may cause damage to the appliance or lead to skin infections.

Chapter 5 Troubleshooting

Disconnect the appliance from the power supply and then turn it on again after at least 3 minutes. If the appliance still does not work properly, please contact your customer service center or your retailer.

	Do not attempt to disassemble, modify or repair the appliance. This may cause an electric shock, short circuit or fire.	
Condition	Possible cause	Solution
Basic functions		
Shower system does not work	No power supply	Wait for the power supply to be restored
	Damage to the electrical connection	Shut down the water supply Disconnect the power supply Call service
	RCD is off	Turn the RCD on
	Standby mode off	Turn on the appliance by pressing the button on the side panel
Water leakage	Shower system failure	Shut down the water supply Disconnect the power supply Call service
Remote control / Control knob		
Remote control LED flashes during operation	Low battery level	Replace the batteries
Remote control / Control knob does not work	No battery	Install the batteries
	Discharged batteries	Replace the batteries
	Incorrectly inserted batteries	Insert the batteries correctly paying attention to '+' and '-' poles
	Remote control failure	Call the customer service helpline
	Brak połączenia pilota zdalnego sterowania / pokrętła sterującego z bazą myjącą	Przeprowadź parowanie pilota zdalnego sterowania / pokrętła sterującego (pkt. 3.1.2 i 3.1.4.)

Standard wash / Feminine wash		
Switching between standard and feminine wash takes too long	When switching between standard and feminine wash modes, the spray head retracts and self-cleaning is performed.	No user intervention is required
Water does not flow from the nozzle or the spray nozzle does not extend	No water supply	Wait for the water supply in the water supply system to be restored
	The water shut-off valve is closed	Open the water shut-off valve
	Abnormalities in the water supply to the appliance	Call the customer service helpline or call service
	Clogged or scaled nozzle	Clean the nozzle / Perform the system descaling process
Water spray intensity too weak	Water spray intensity is set to "1"	Set the water spray intensity to 2, 3, 4 or 5
	Clogged nozzle	Clean the nozzle / Perform the system descaling process
	Clogged filter on water inlet line	Clean or replace the water filter
	Abnormalities in the water supply to the appliance	Call the customer service helpline or call service
Too cold water	Water heating is set to the lowest level	Set the water temperature to 2, 3, 4 or 5
Too warm water	Water temperature is set to "5"	Set the water temperature to 1, 2, 3 or 4
Water spray from the spray nozzle suddenly stops	Function stops automatically after 3 minutes	No user intervention is required
Water dripping out of retracted nozzle	The nozzle is automatically rinsed before and after washing	No user intervention is required

Contact the customer service helpline or an authorized service technician when:

- LED on the side panel of the toilet flashes after connecting the power supply,
- LED on the side panel does not light up after switching the power on again,
- the appliance emits smoke or abnormal sounds.

In each of the above cases, disconnect the appliance from the power supply.

Chapter 6 Technical data

Model		
Water connection type		G 1/2
Supply voltage		AC220-240V, 50/60HZ
Permissible feed water pressure		0,07~0,7MPa (0,7~7,0 Bar)
Permissible feed water temperature		4 ~ 35°C
Permissible ambient temperature		4 ~ 40°C
Water resistance class		IPX4
Shower system	Water flow	500 ~ 650ml / min
	Spray temperature range	31 ~ 39°C
	Washing cycle duration	3 minutes
	Type of water heater	Flow-through heater
	Heating power	1200W
	Protection devices	Thermal fuse, thermostat
Protection against water back up		Check valve, air gap
Net weight of the shower system with the seat		33kg
Dimensions of the shower system with the seat		510*360*525mm

Meissen Keramik

Thank you for trusting us